

SOONEC

For AIoT & Digital transformation solutions

WIRELESS DIGITAL MONITORING ADAPTER



SN: FH303B03

TEMPREATURE & HUMITURE INSTRUCTIONS

Function Definition

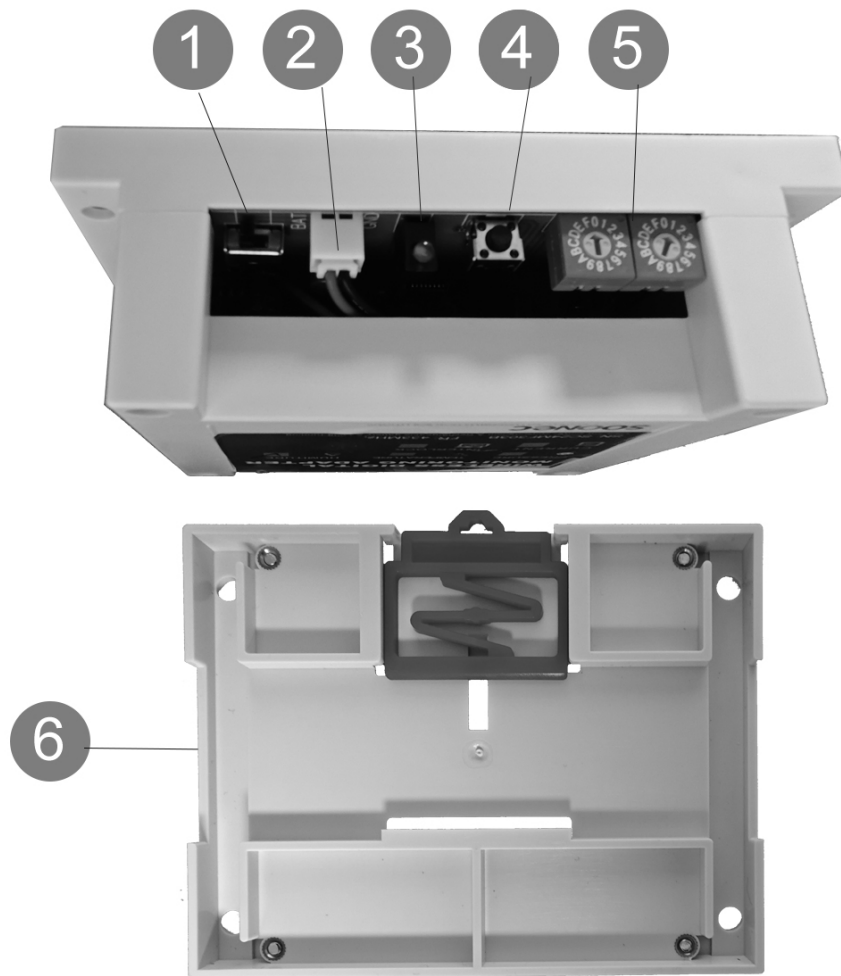

- 1.Power switch
- 2.Battery power supply port
- 3.Led Lamp
- 4.Manual collection button,Press for collection
- 5.Address setting knob
- 6.International standard card rail groove

Installation



Magnet installation or wall mounted

Step 1. Fix the card rail to the wall

Step 2. Fix the sensor on the clamp rail

Specification

Work environment: -20 ~ +80°C, 10%~90%RH

Work voltage: 3.7v

Consumption: 70μ A

Battery: 2000Ah ,Rechargeable

Accuracy: Temp. 0.1°C Humi. 1%RH

Measuring Range: Temp.-10~120°C Humi.0~100%RH

Size Information

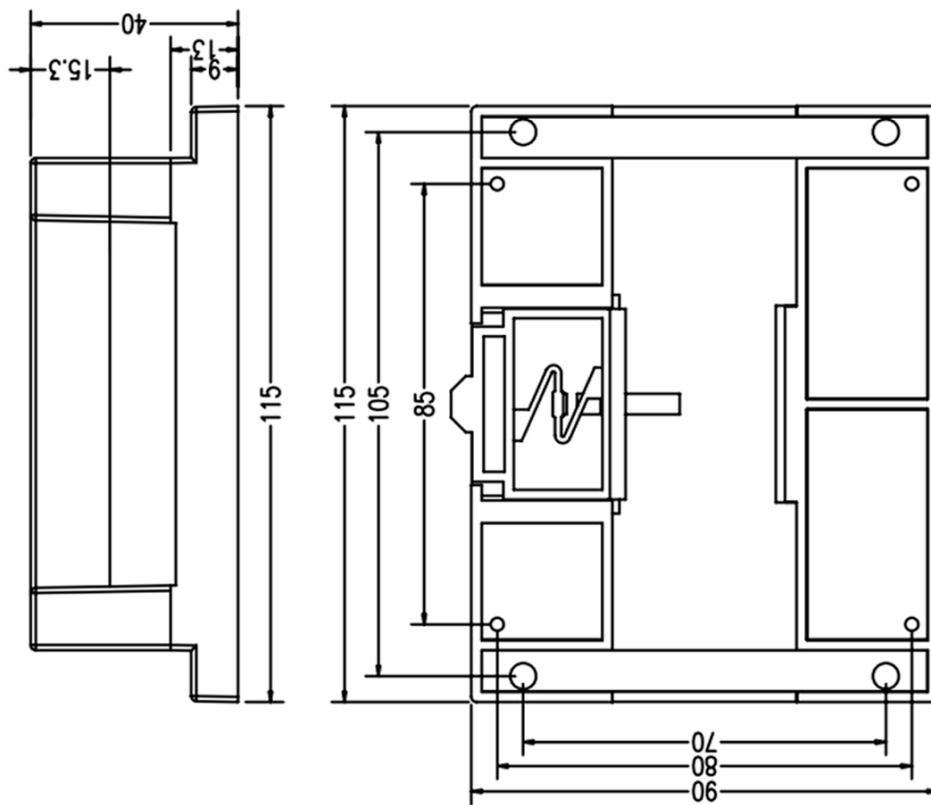

View More



Guangdong Soonec Network Technology Co., Ltd.

 service@soonec.com

 <http://www.soonec.com>

SOONEC

For AIoT & Digital transformation solutions